

# 1 Introduction

## Please confirm

- 1 The device appearance is not damaged.
- 2 Confirm all the accessories according to the checklist.

## Checklist:

- ◆ Villa VTO ◆ Quick start Guide ◆ Screw Package

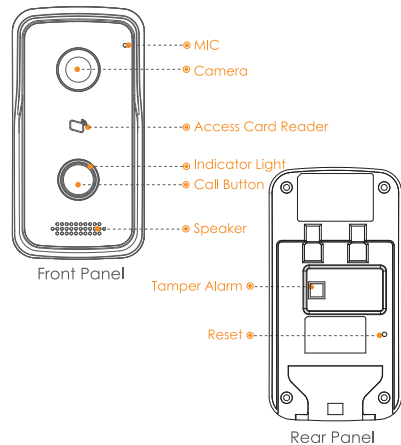

# 2 Installation

Configure the device **first**, and then install it.

- 1 Drill screw holes on the mounting surface according to those on the mounting plate.
- 2 Put the expansion bolts in the screw holes.
- 3 Attach the mounting plate to the mounting surface with the screws.
- 4 Fix the VTO on the mounting plate with the screw.
- 5 Put silicone sealant between the VTO and the mounting surface.

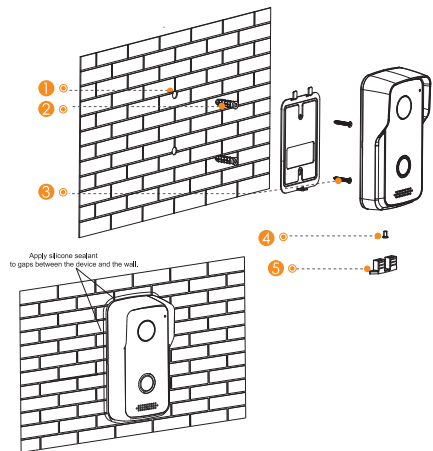

# 3 Installation and Adding Device

Scan the following QR code to download and install the app .



Before adding the door station (VTO) to the gDMSS Plus, you need to modify IP address of the door station (VTO), make sure that the door station (VTO) and the router are connected to the same network, and connect the door station (VTO) to the power source.

- 1 On your mobile phone, tap , and then follow the onscreen instructions until the region selection interface is displayed.
- 2 Select a region.
- 3 Tap **Done** on the upper right corner of the interface. The **Live** interface is displayed.

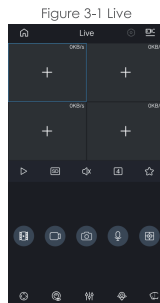
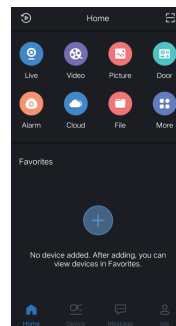

Figure 3-1 Live

- 4 Tap on the upper left corner of the **Live** interface. The **Home** interface is displayed.

Figure 3-2 Home



- 5 Tap on the **Home** interface. The **Device Manager** interface is displayed.
- 6 Tap on the upper right corner of the **Device Manager** interface.

Figure 3-3 Device manager

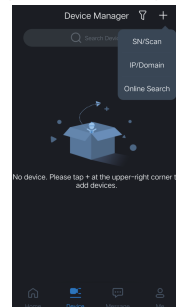

- 7 Tap **IP/Domain**. The **Add Device** interface is displayed.

Figure 3-4 Add device

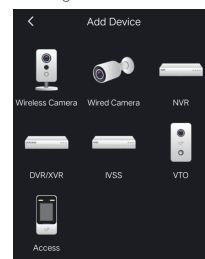

- Tap **VTO** on the **Add Device** interface. The **Default Page** is displayed.

Figure 3-5 Default page

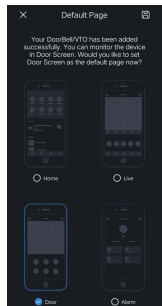

For more details about adding devices, refer to the DMSS Plus App User's Manual-V1.0.0

- Tap **Door**. The **Add Device** interface is displayed.

Figure 3-6 Add device

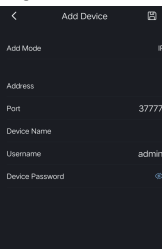

- Enter Address (IP address of the door station (VTO)), Device Name, and Device Password.



You need to subscribe alarm messages, and then alarm messages can be pushed to the App. On the **Alarm** message interface, tap to select a door station (VTO), and then alarm messages related to the door station (VTO) will be pushed to the App.

- Tap . The door station (VTO) is added. You can watch videos captured by the door station (VTO), call the door station (VTO), unlock doors when there is call from the door station (VTO), and more.

Figure 3-7 Door

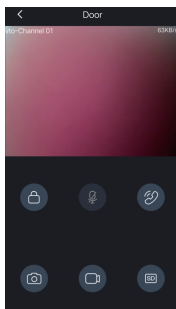

## 4 Safeguards and Warnings

The following description is the correct application method of the device. Please read them carefully before use to prevent danger or property loss.

### Operating Requirement

- Do not place and install the device in an area exposed to direct sunlight or near heat generating device.
- Do not install the device in a humid, dusty or fuliginous area.
- Please keep its horizontal installation, or install it at stable places, and prevent it from falling.
- Do not drip or splash liquids onto the device; don't put on the device anything filled with liquids, in order to prevent liquids from flowing into the device.
- Please install the device at well-ventilated places; don't block its ventilation opening.
- Use the device only within rated input and output range.
- Do not dismantle the device arbitrarily.
- Please transport, use and store the device within allowed humidity and temperature range.

### About the Manual

- The Manual is for reference only, and the actual product shall prevail.
- All the designs and software are subject to change without prior written notice.
- All trademarks, registered trademarks and the company names in the manual are the properties of their respective owners.
- Please visit our website, contact the supplier or customer service if there is any problem occurred when using the device.
- If there is any uncertainty or controversy, please refer to our final explanation.

## 5 FAQ

- The device is not operating normally.**  
Please reset the device and configure it again.

- How to reset the device.**  
Press and hold the reset button for 10 s.

- Device is offline.**

If the device indicator light keeps flashing with blue light, then it is offline. You need to check your network connection, and if the network connection is normal, you can reset and configure the device again.

## Quick Start Guide

### Villa VTO

V1.0.0