

## AP MODE WIFI CONNECTION FOR WIFI DOOR PHONE



Preparation before connecting the wifi monitor with the wifi router.

- \* WIFI indoor monitor + adapter, outdoor station, 2.4G wifi router, smart mobile phone.
- \* Make sure that the wifi indoor monitor, outdoor station and the adapter are right connection, and charging the power.
- \* Make sure that the 2.4G wifi router is online to connect the internet, and your mobile phone connect the 2.4G wifi
- \* Make sure that the smart mobile phone to download the APP “TUYA SMART” from the Google play store or App Store.

**AP mode setup as the below: 2 main steps**

# 1, setting the AP mode on the wifi monitor

Step 1 for setting

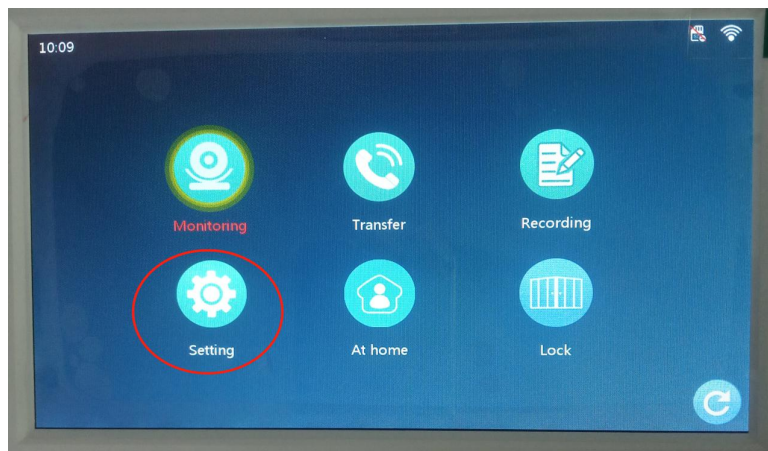

Step 2 for network setting

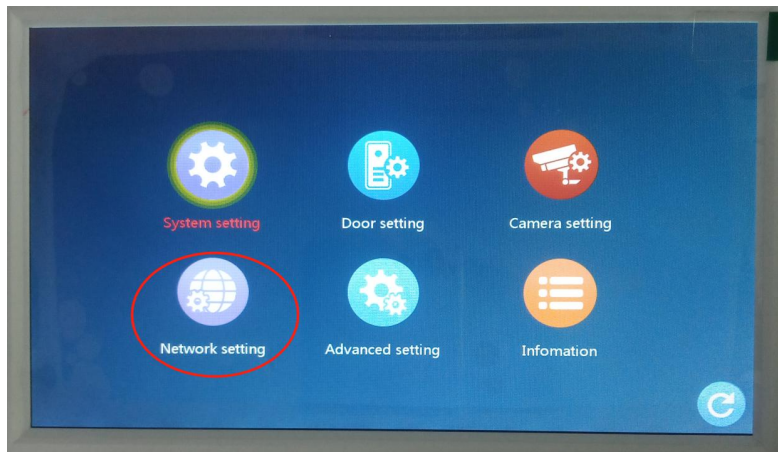

Step 3 for selecting AP mode

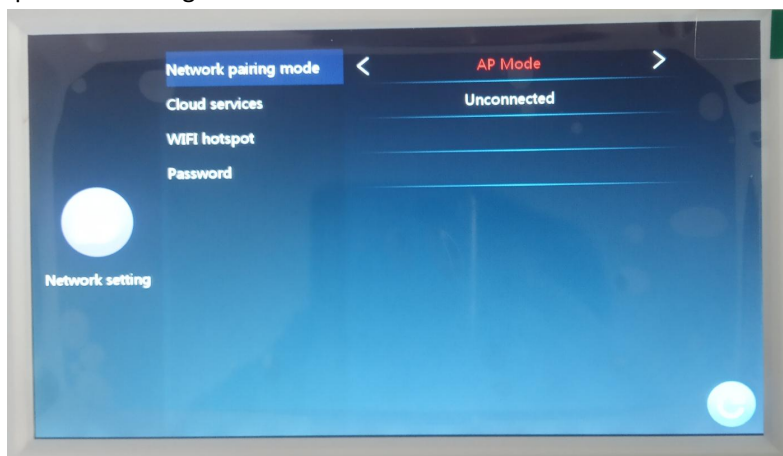

## 2, TUYA SMART APP pairing the AP mode.

Step 1 for adding,

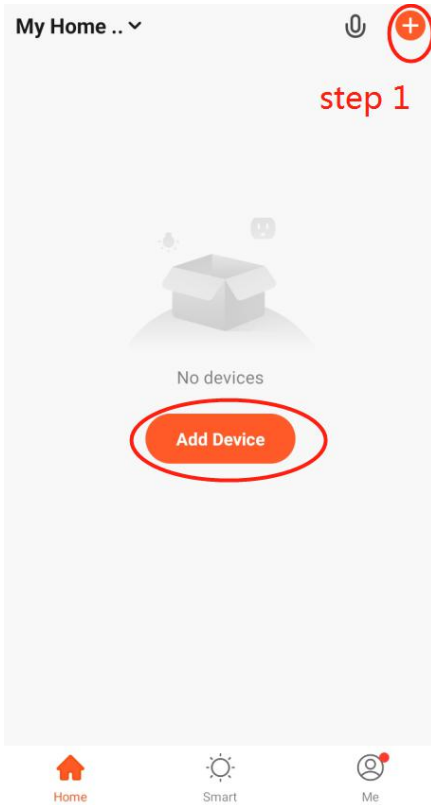

Step 2 and 3

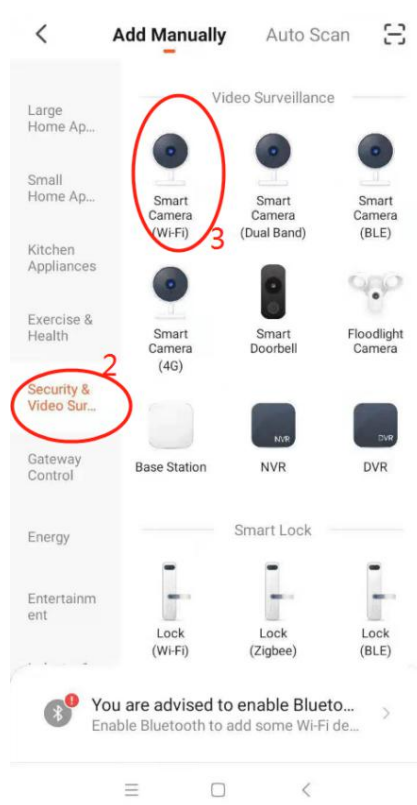

Step 4 for selecting AP mode

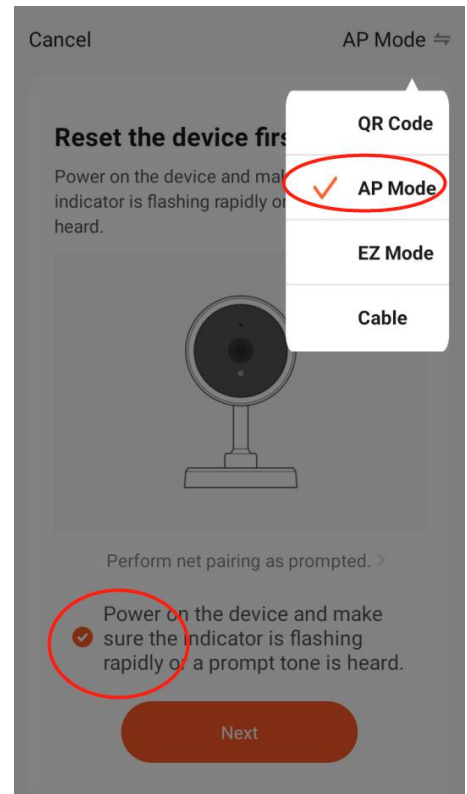

Step 5 for selecting 2.4G WIFI

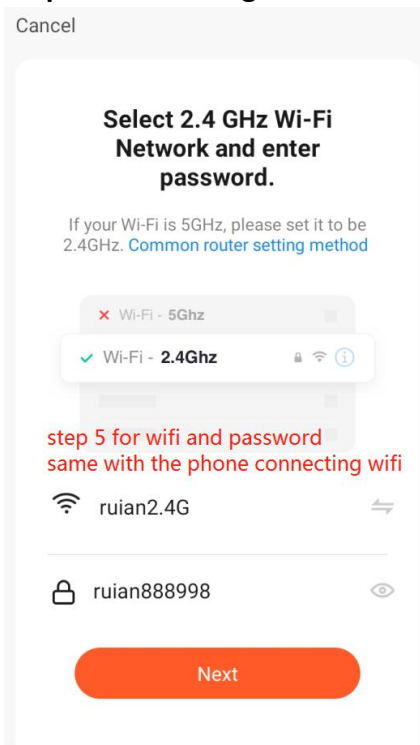

Step 6 for checking

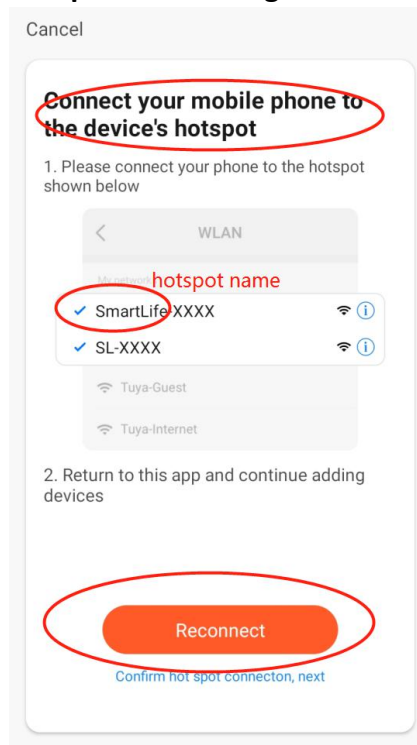

Step 7 for selecting smart life

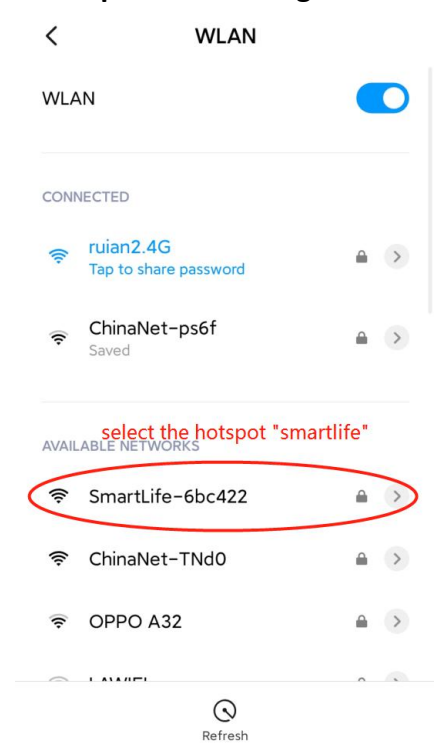

Step 8 for input the hotspot password 12345678 Step 9 for adding

Step 10 for done

